

QUICK START GUIDE
Classic 10

1

Refer to the operation manual and pay attention to all the warnings and cautions throughout the manual

Typical Installation Options

CONDITION TO USE OPTION 1
No negative air pressure** in the room and the temperature of the infiltrated air is below the room temperature. Operating temperature Range: Between 70 °F (21 °C) to 105 °F (40 °C)

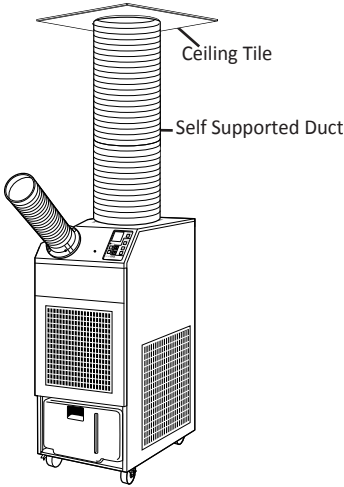

Accessory Name*	Part Number	Quantity
Ceiling Tile	LA146373-8280	1
Self Supported Duct	481744-0060	1
Warm Air Flange Kit	481170-0191	1

CONDITION TO USE OPTION 2
Negative air pressure** in the room. Operating temperature Range: Between 70 °F (21 °C) to 105 °F (40 °C)

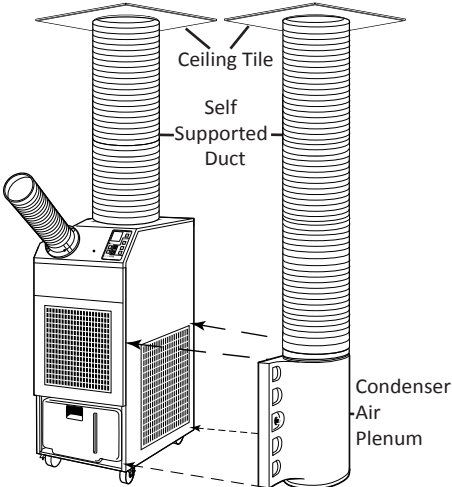

Accessory Name*	Part Number	Quantity
Ceiling Tile	LA146373-8280	2
Self Supported Duct	481744-0060	2
Condenser Air Plenum	LAY84270-0040	1
Warm Air Flange Kit	481170-0191	1

*Accessories Sold Separately

NOTE:
• Ensure that the warm air moves away from the ceiling and the heat is dissipated. If your application does not meet this requirement, then extend the duct to the nearest exhaust point based on the Maximum Equivalent Length listed in the operation manual.

** The combination of the following could create **negative air pressure**:
- MovinCool unit is installed and runs using OPTION 1.
- Door to the room is closed.
- No other source of air entering the room.

3

- Place the duct over the flange on the top of the unit (see figure below).
- Again hold the duct firmly, about 1 ft away from the end over the flange (see figure below).
- Rotate the duct end counterclockwise until the diameter reduces to an appropriate size (see figure below).

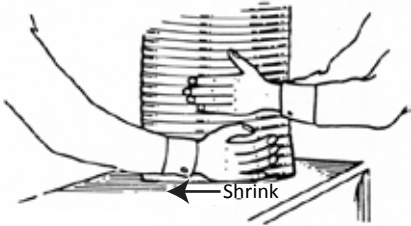

• Warm air duct attachment to the ceiling tile:

- Holding the other end of the duct firmly about 1 ft away from the end, rotate the end of the duct counterclockwise to decrease the diameter of the duct enough to pass through the 12” hole in the ceiling tile.

- Pass the duct through the 12” hole on the ceiling tile (see below).

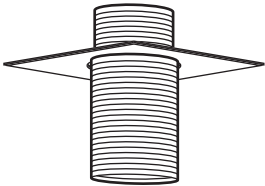

- Repeat the step number 1) but this time rotate the end of the duct in clockwise directions until duct diameter increases enough to lock inside the ceiling tile (see below).

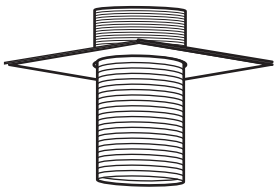

• Removal of original ceiling tile:

Remove the original selected ceiling tile from the ceiling (if the tile is 2’ x 4’, then cut the tile into 2’ x 2’ and place one piece back into the ceiling at the end).

• Installation of the ceiling tile with the duct:

Place the ceiling tile (with the duct) inside the ceiling.

2

NOTE: Refer to the operation manual for details on choosing the installation site

A) Roll the unit into the space that needs cooling

• Moving the unit and installation of cold air outlet ducts:

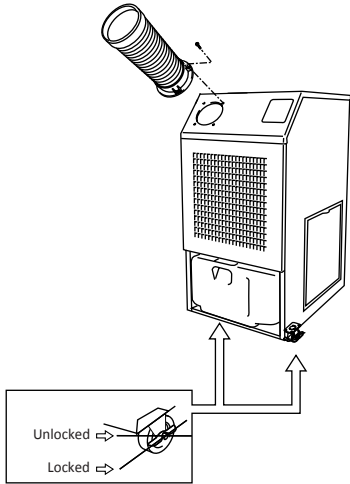

- Unlock the casters and move the MovinCool unit to a flat, level surface and set the casters back to the LOCKED position.
- Install each cool air outlet duct using 4 screws each as shown.
(1 cool air outlet duct included with the unit).

B) OPTION 1 set up steps

• Warm air flange attachment to the unit:

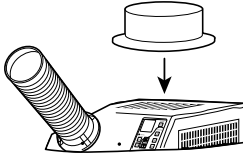

- Attach the warm air flange using the screws included with it.

• Warm air duct attachment to the unit:

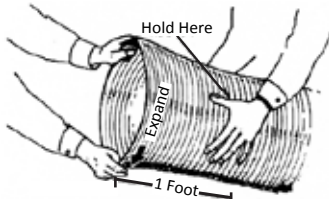

- Hold the duct firmly, about 1 ft away from the end.
- Rotate the end of the duct clockwise to increase the duct diameter (see figure). This procedure usually takes 2 people.

4

C) OPTION 2 set up steps

• Condenser Air Plenum Installation:

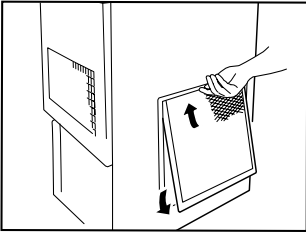

- Remove the filter frame assembly from the condenser side panel by lifting them up and tilting outward at the bottom as indicated by the arrows above.

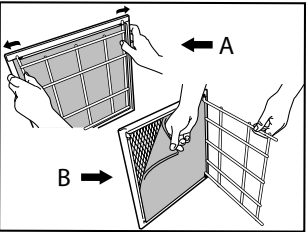

- Remove the filter elements from the filter frames by pressing outward on the re-tainer at the indicated points (A), then, opening the retainer (B). (Save the filter frames for future use).

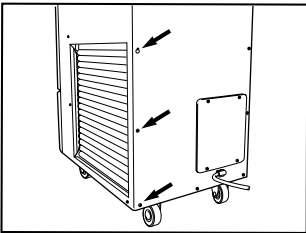

- Temporarily remove the three (3) screws from the rear panel of the unit. (Save the screws for step 5 below).

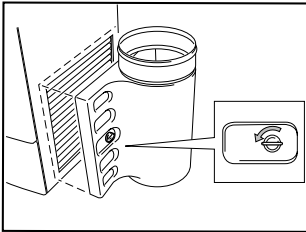

- Turn the latch of the Air Plenum counterclockwise until it stops. Place the Air Plenum over the condenser openings and align the hinge/bracket assembly mounting holes with the respective screw holes on the back of the unit.

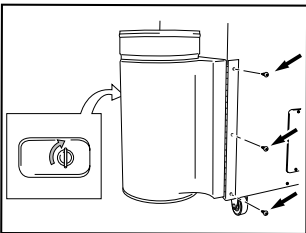

- For ease of installation, turn the latch to the full clock-wise position. (This will hold the front part of the Plenum onto the unit). Attach the hinge/bracket of the Air Plenum to the rear of the unit using the original three (3) screws that were temporarily removed in step 3.

C) Option 2 set up steps (continued...)

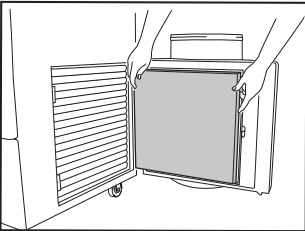

6) Open the Air Plenum by turning the latch counterclockwise and install the air filter element (from the filter frame) onto the Air Plenum (as indicated).

7) Close and secure the Air Plenum to the unit.

• Warm air duct installation to the plenum and ceiling tile

Follow the steps shown in the option 1.

D) Power up the unit:

Plug the unit and turn it on.

Note:

Voltage Requirement: 1 phase, 115V

Recommended Fuse Size: 15 amps

NEMA Plug Configuration: 5-15

All Optional Accessories:

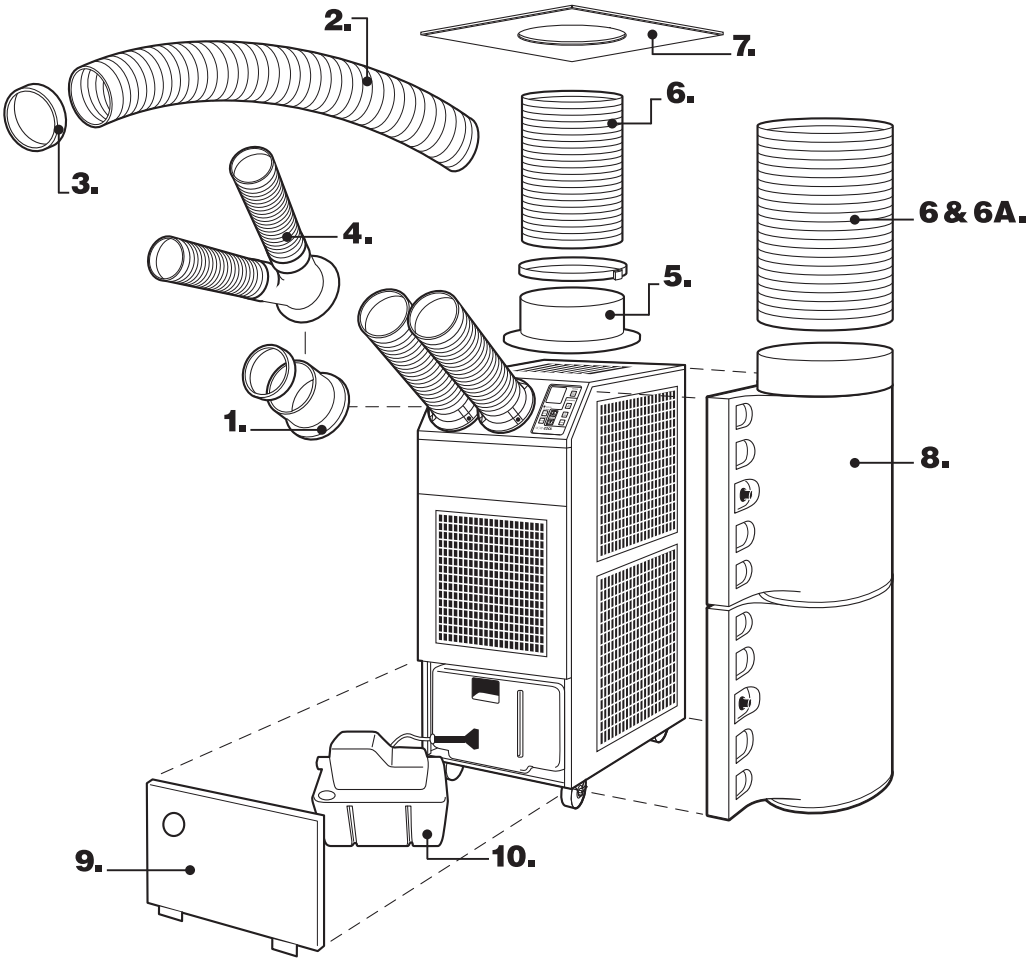

	Part Name	Part Number	Purpose
1	Cold Air Flange Kit	481170-0180	Cold air supply.
2	Cold Air Extension Duct	481744-0090	Spot or remote cooling.
3	Trim Ring	481851-0200	End cap of cold air self supported duct.
4	Dual Duct	484209-0030	Spot or remote cooling.
5	Warm Air Flange Kit	481170-0191	Condenser heat removal.
6	Self Supported Duct	481744-0060	Condenser heat removal or intake.
6A	Warm Air Flexible Duct Kit	LAY45771-0060	Condenser heat removal or intake..
7	Ceiling Tile	LA146373-8280	Condenser heat removal or intake
8	Condenser Air Plenum	LAY84270-0040	Condenser air intake.
9	Cover Plate	484009-0480	To cover the condensate tank or pump.
10	Condensate Pump Kit	LA484789-0121	Removes the condensate water automatically.